

# CAMPAGNE DU PETIT BAULERS PUC G

RUE DE FRANCE À NIVELLES

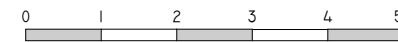
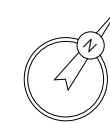
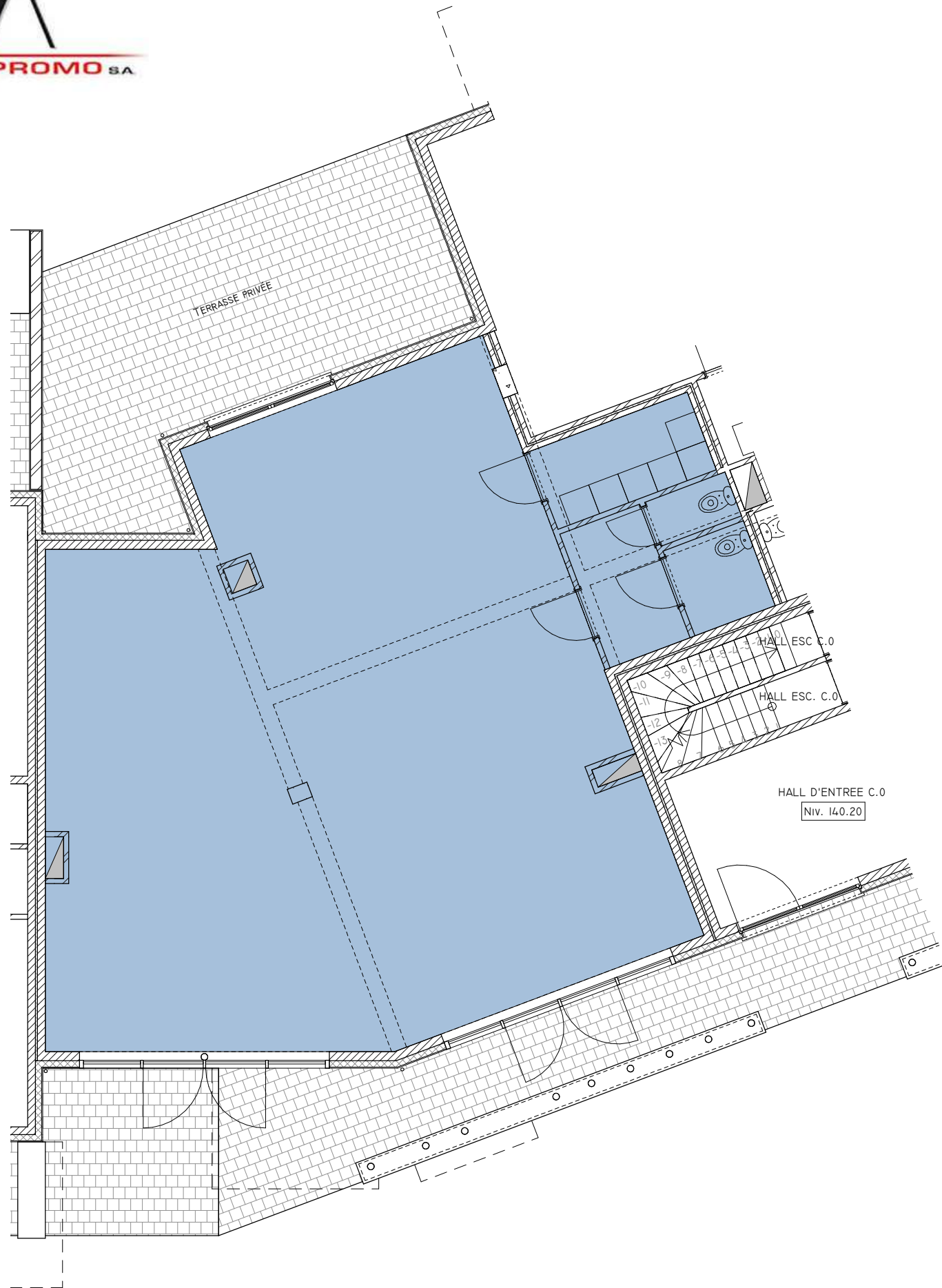

## COMMERCE C.0.2

SALLE PRINCIPALE :	± 123M <sup>2</sup>
CUISINE :	± 5,1M <sup>2</sup>
HALL SANITAIRES :	± 4,5M <sup>2</sup>
WC 1 :	± 1,5M <sup>2</sup>
WC 2 :	± 2,9M <sup>2</sup>

**SURFACE BRUTE : ±148M<sup>2</sup>**

TERRASSE JARDIN : ±34,7M<sup>2</sup>

